

# The Automated Purlin Rollformer

## Cee Plus Sigma

Material Thickness: 0.040" - 0.200"  
Web Width: 8" - 20"  
Leg Height: 3" - 5"

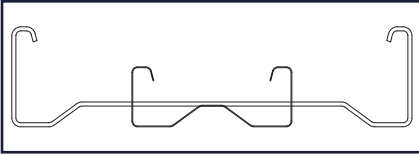

## Cee Sigma

Material Thickness: 0.040" - 0.200"  
Web Width: 8" - 20"  
Leg Height: 2.750" - 5"

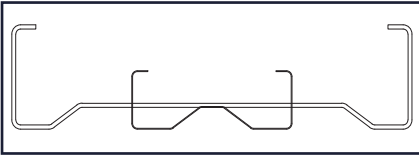

## Cee Plus Purlin

Material Thickness: 0.040" - 0.200"  
Web Width: 4.750" - 20"  
Leg Height: 3" - 5"

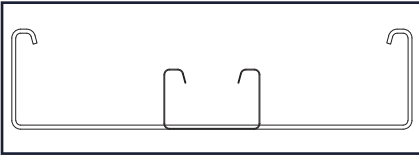

## Cee Purlin

Material Thickness: 0.040" - 0.200"  
Web Width: 4" - 20"  
Leg Height: 2" - 5"

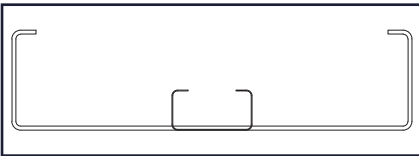

## Zee Purlin

Material Thickness: 0.040" - 0.200"  
Web Width: 4" - 20"  
Leg Height: 2" - 5"

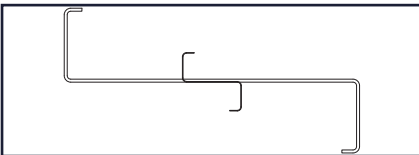

## U-Channel

Material Thickness: 0.040" - 0.200"  
Web Width: 4" - 20"  
Leg Height: 2" - 5"

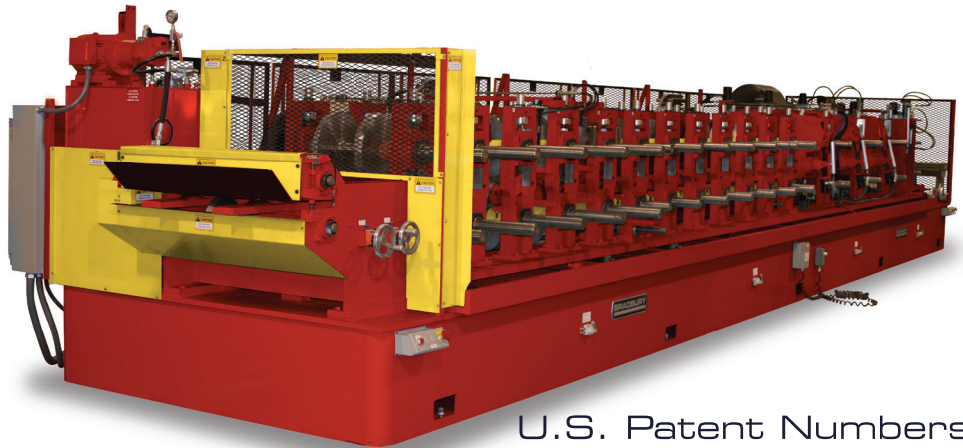
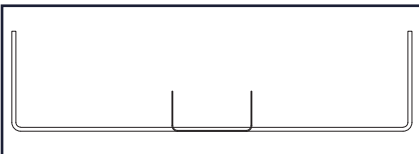

U.S. Patent Numbers  
5,983,691 6,216,514  
8,453,485 5,829,295  
6,434,994 6,209,374

## Automated Gauge Change

The QTR™ is the fastest changing rollformer in the industry. The double-faced forming tools that make this possible are mounted solidly in a fixed position and never need adjustment. The side forming of these rolls has the added benefit of eliminating scuffing. The Bardie™ Cartridge is an exclusive feature on the QTR™ which provides automatic gauge adjustment.

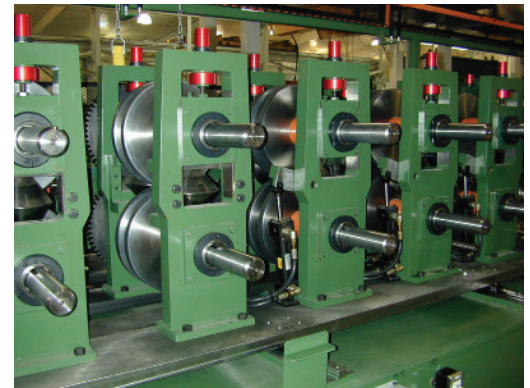

## Automated Part Retrieval

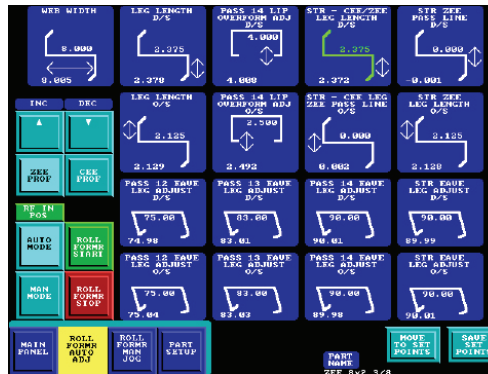

The QTR™ tooling is equipped with hydraulic motor and cylinder adjustment controls. The positioning of each tool is controlled and displayed on a Bradbury TSC™ touch screen operator interface. The combined settings for each tool make up a part profile. These part profiles can be created, modified, stored, and retrieved for automatic set up of the QTR™ tooling. All position adjustments also have manual override control through the TSC™ operator interface.



## Singled Sloped Eave

Material Thickness: 0.040" - 0.200"  
Web Width: 4" - 20"  
Leg Height: 2.500" - 5"

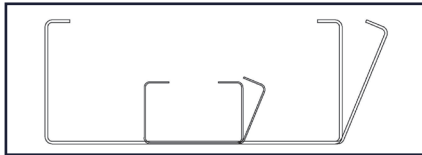

## Double Sloped Eave

Material Thickness: 0.040" - 0.200"  
Web Width: 6" - 20"  
Leg Height: 2.500" - 5"

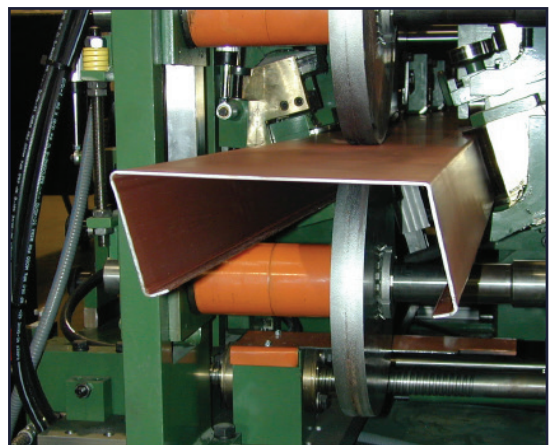
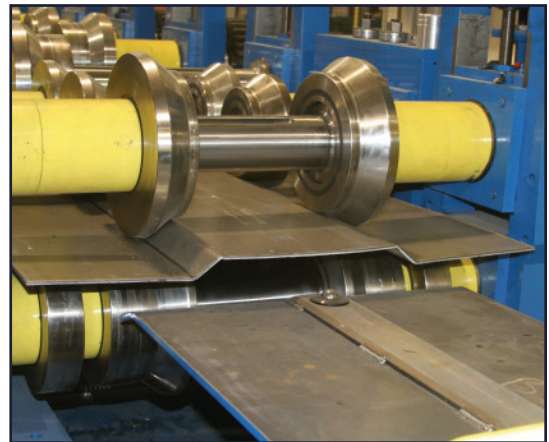
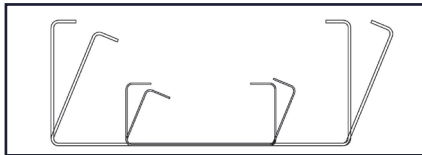

- Infinitely Variable 1 on 12 to 5 on 12 In-line Eave Forming
- Increased Productivity
- Reduced Setup Time
- Simplified Maintenance
- Less Floor Space Required
- Simple Cee to Zee Changeover
- Fewer Moving Parts
- Automated Gauge Change
- Proven Tooling Progression
- Lips First Forming
- No Air Forming
- Superior Automatic Anti-Flare Unit
- Superior Anti-Twist Unit
- Reduced Scrap
- Production Friendly Guards

